

# PENTARCH DESIGNS PRIVATE LIMITED

162/B/324, LAKEGARDENS, KOLKATA 700 045

PROJECT RAJ SUNITI AT PREMISES NO. 43/8A, JHEEL ROAD, WARD NO.- 92, BOROUGH - X, KOLKATA - 700031, P.O.- K.P.ROY LANE, P.S.- GARFA, DAG-1701, KHATIAN - 806, MOUZA-DHAKURIA.

LAND AREA = ( 04 K.- 0 CH.- 0 SQ.FT.) = 267.561 SQM.

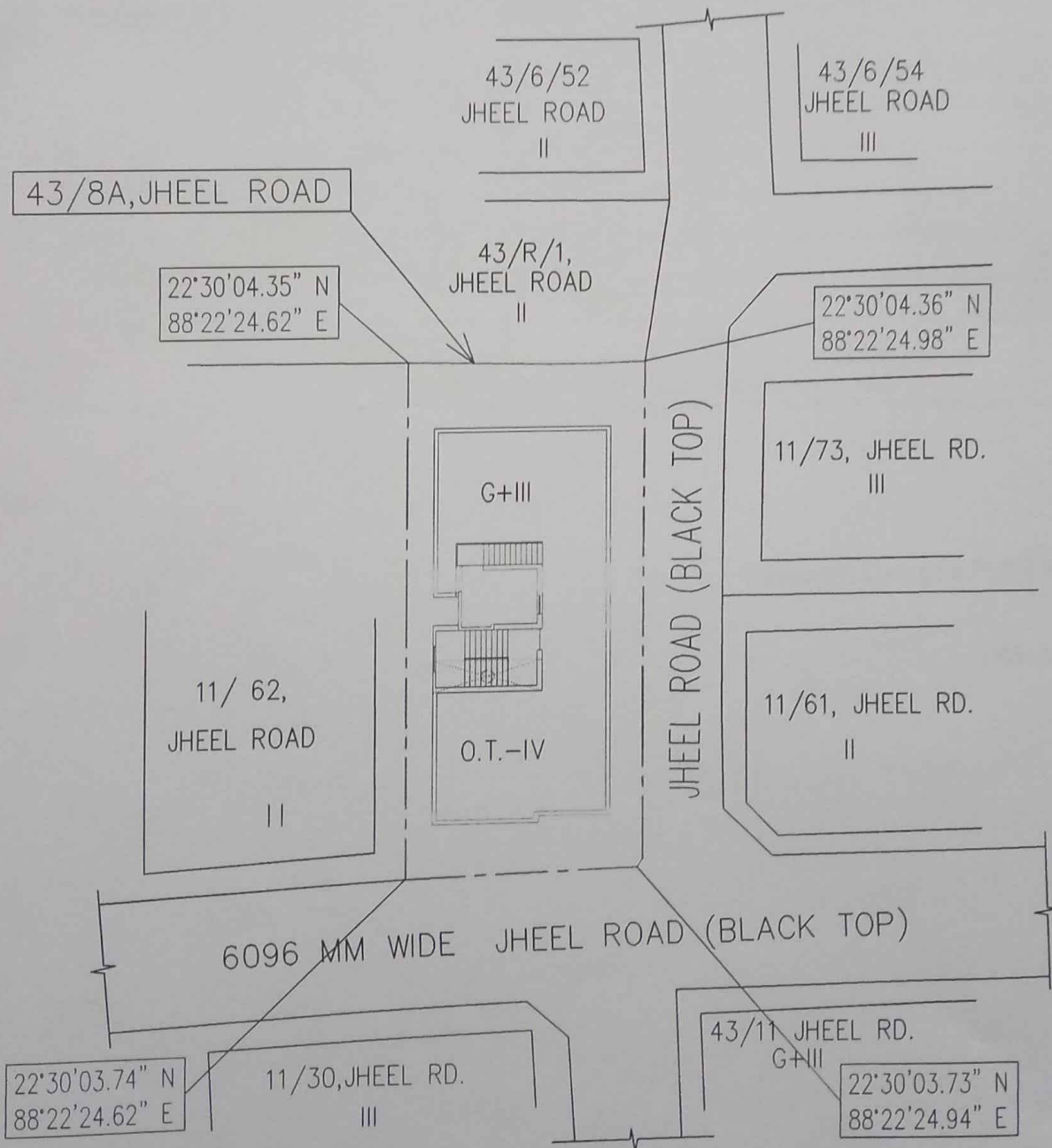

SITE PLAN (SCALE=1:300)

Pentarch Designs Pvt. Ltd.

*[Signature]*  
Director